

Installation Overview

General placement of components

D00162 A04 1/3

Customer or Staff Facing

Freepour Batch can be installed facing your customers or staff.

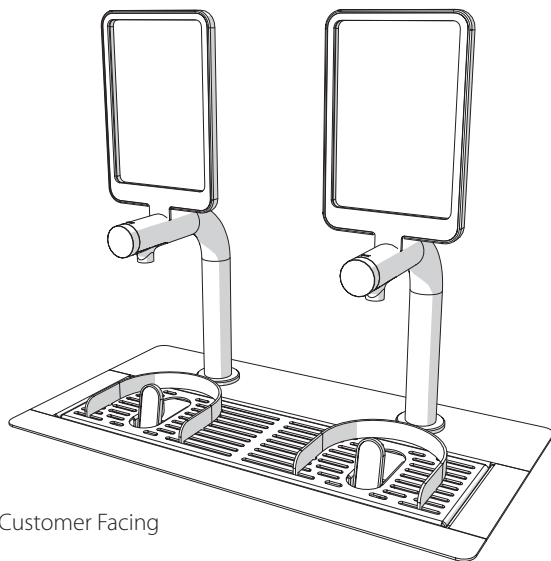

Customer Facing

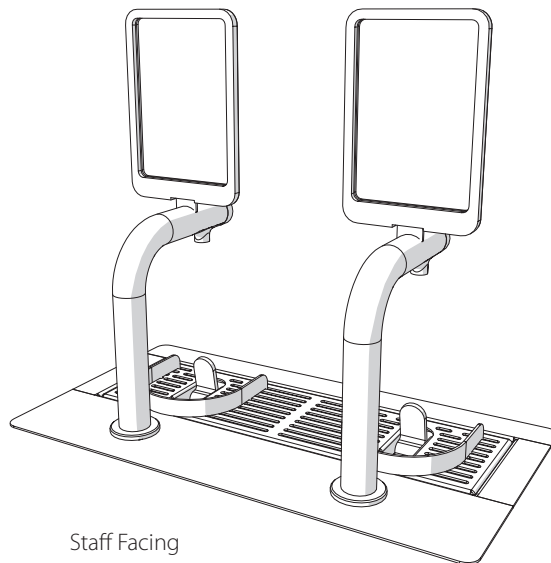

Staff Facing

Mounting the Control Unit

The Airpot Frame has holes in the sides which make it possible to mount the Control Unit on the left or right side of the frame. Rubber feet on the controller mean you can also sit it on a shelf. An optional side mounting bracket can also be ordered.

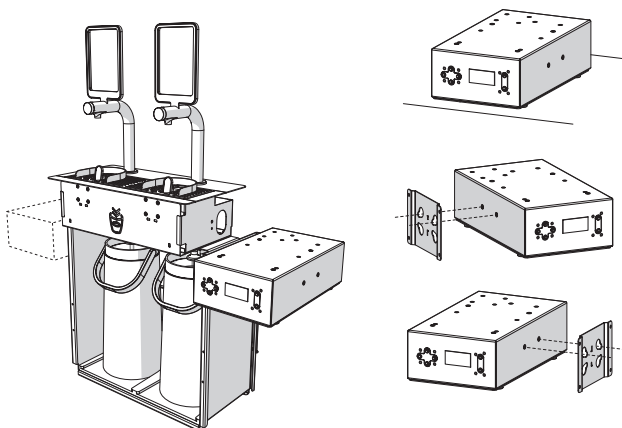

Integrated mounting bracket

The optional mounting bracket can be used on either side of the Control Unit.

Loading

Airpots can be loaded from the front or from the back of the dispenser. A reversible airpot guide in the base of the Airpot Frame makes sure the airpot is properly aligned with the connector.

The airpot automatically connects as it is pushed into place and is very easily disconnected. This means the unit can be installed a fair distance under the bar and still be easy to load and restock.

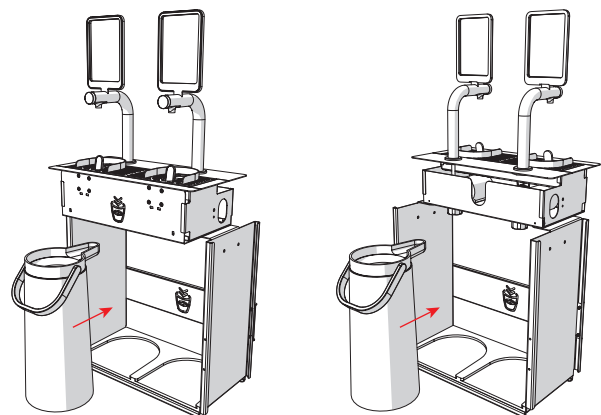

Front Loading

Rear Loading

Installation Guidelines and Dimensions

Freepour Batch Single

D00162 A04 2/3

Single Dispenser

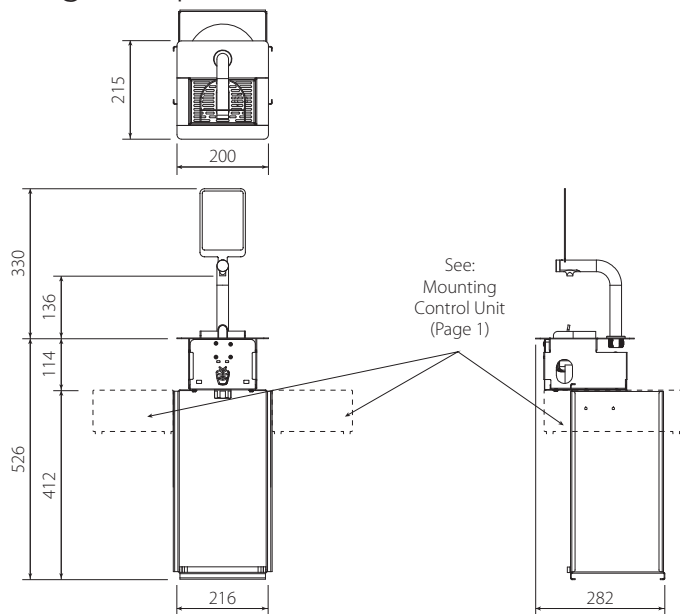

Control Unit

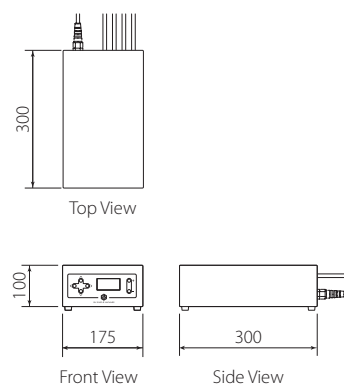

Dimensions shown are in millimetres

Placement of the Dispenser

For good ergonomic operation we recommend the dispenser is set around 150 to 200mm in from the edge of the counter.

When deciding on this position also consider the undercounter space requirements and how this may be affected by the construction of your bench and other underbench items. Ensure you have allowed space to easily load airpots and to provide access for service personnel.

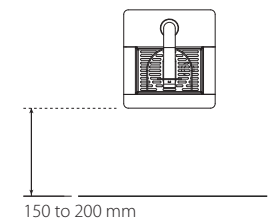

Installing the Dispenser

A rectangular hole in the bench must be provided for the Dispenser.

The dispenser is lowered through the cut-out (A) and then the Airpot Frame is attached to the dispenser from below (B).

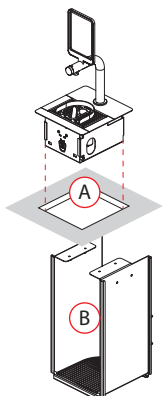

Size of cut-out required

Freepour Batch Single:
180 wide x 195mm deep

Clearance under the Bench

When planning the installation it is important that you leave at least 50 mm around the undercounter items and that you leave a clear path for the airpots to be loaded.

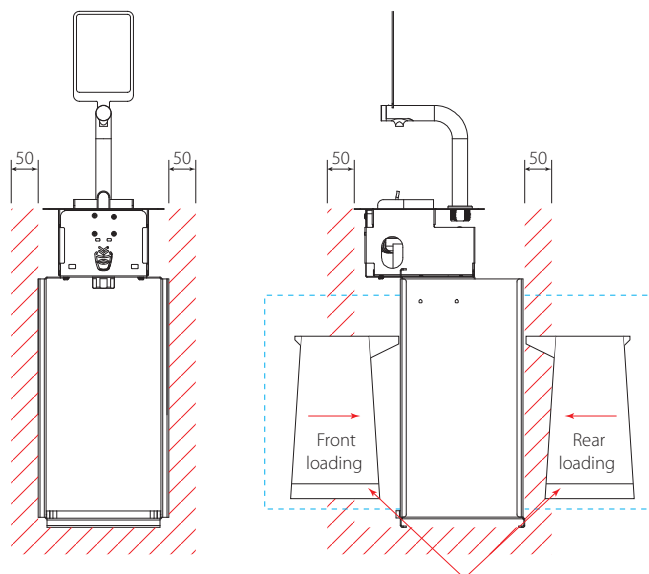

Allow space to load airpots from either the front **or** from the rear. It is not necessary to provide access for front **and** rear loading

Power and Drainage

The Control Unit requires 1 x 10A GPO.

The Freepour dispenser is connected to a drain via flexible PVC hose.

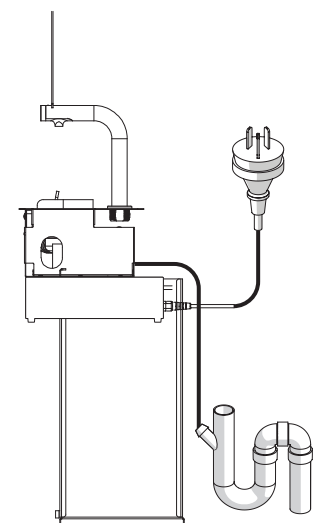

Services required on-site

Power: 1 x 10A GPO

Drain: Access to a drain

Installation Guidelines and Dimensions

Freepour Batch Double

D00162 A04 3/3

Double Dispenser

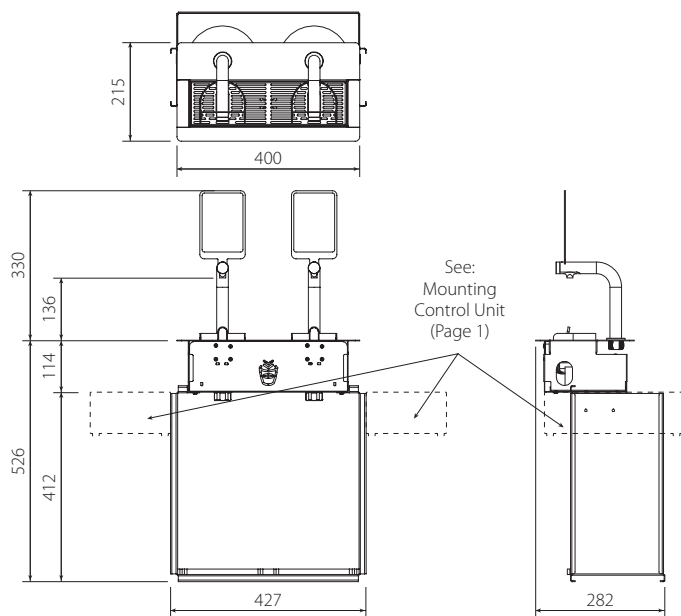

Control Unit

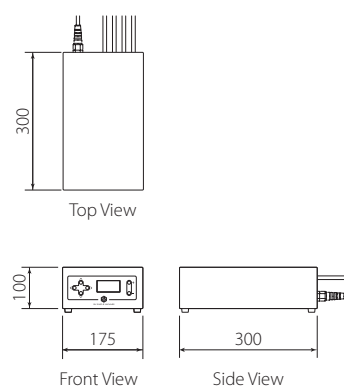

Dimensions shown are in millimetres

Placement of the Dispenser

For good ergonomic operation we recommend the dispenser is set around 150 to 200mm in from the edge of the counter.

When deciding on this position also consider the undercounter space requirements and how this may be affected by the construction of your bench and other underbench items. Ensure you have allowed space to easily load airpots and to provide access for service personnel.

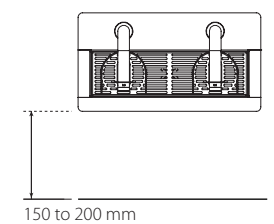

Installing the Dispenser

A rectangular hole in the bench must be provided for the Dispenser.

The dispenser is lowered through the cut-out (A) and then the Airpot Frame is attached to the dispenser from below (B).

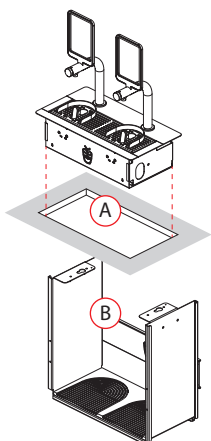

Size of cut-out required

Freepour Batch Double:
380 wide x 195mm deep

Clearance under the Bench

When planning the installation it is important that you leave at least 50 mm around the undercounter items and that you leave a clear path for the airpots to be loaded.

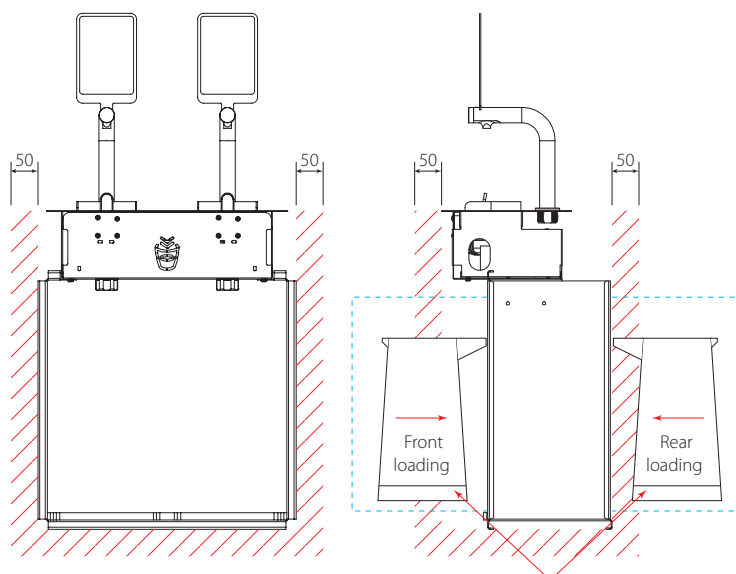

Allow space to load airpots from either the front **or** from the rear. It is not necessary to provide access for front **and** rear loading

Power and Drainage

The Control Unit requires 1 x 10A GPO.

The Freepour dispenser is connected to a drain via flexible PVC hose.

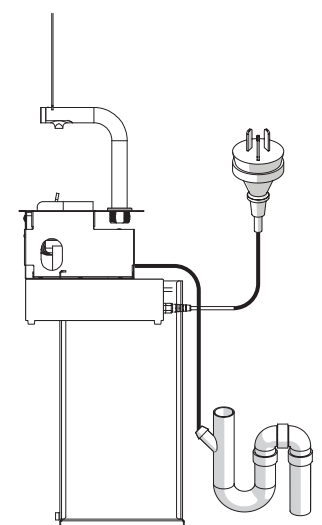

Services required on-site

Power: 1 x 10A GPO

Drain: Access to a drain